

21.Console Box

A: REMOVAL

1) Disconnect the ground cable from battery. <Ref. to NT-5, BATTERY, NOTE, Note.>

NOTE:

- For models other than STI model, disconnect the ground terminal from battery sensor.
- On CVT models, shift the select lever into "D" before disconnecting the battery ground cable.

2) Remove the console box assembly.

(1) Release the claws, and then remove the boot - hand brake.

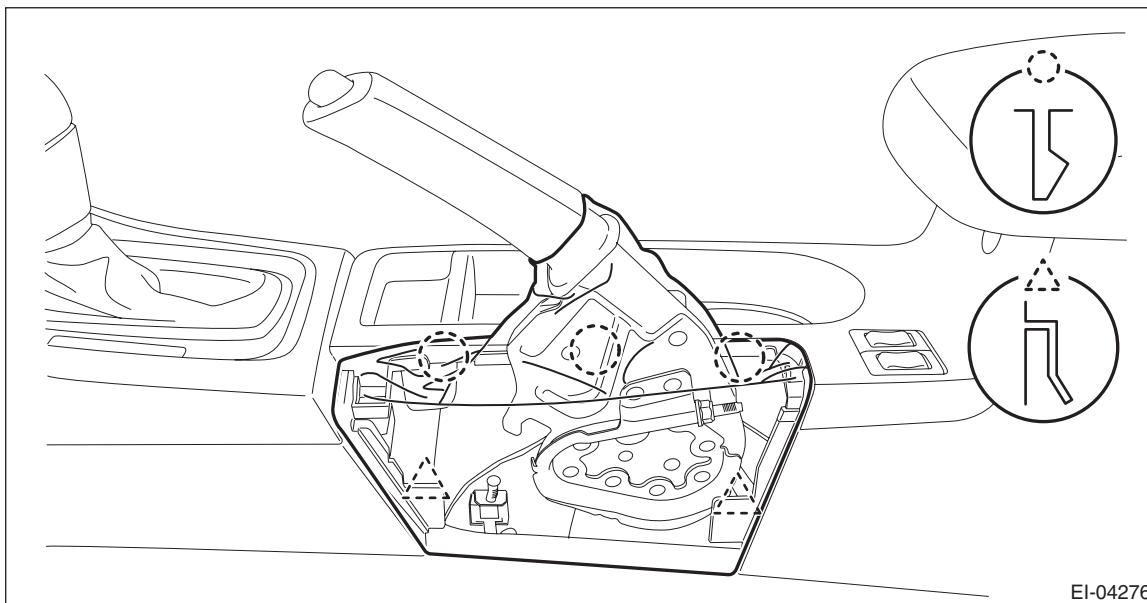

(2) Remove the screws, bolts and clips, disconnect the harness connector and remove the console box assembly.

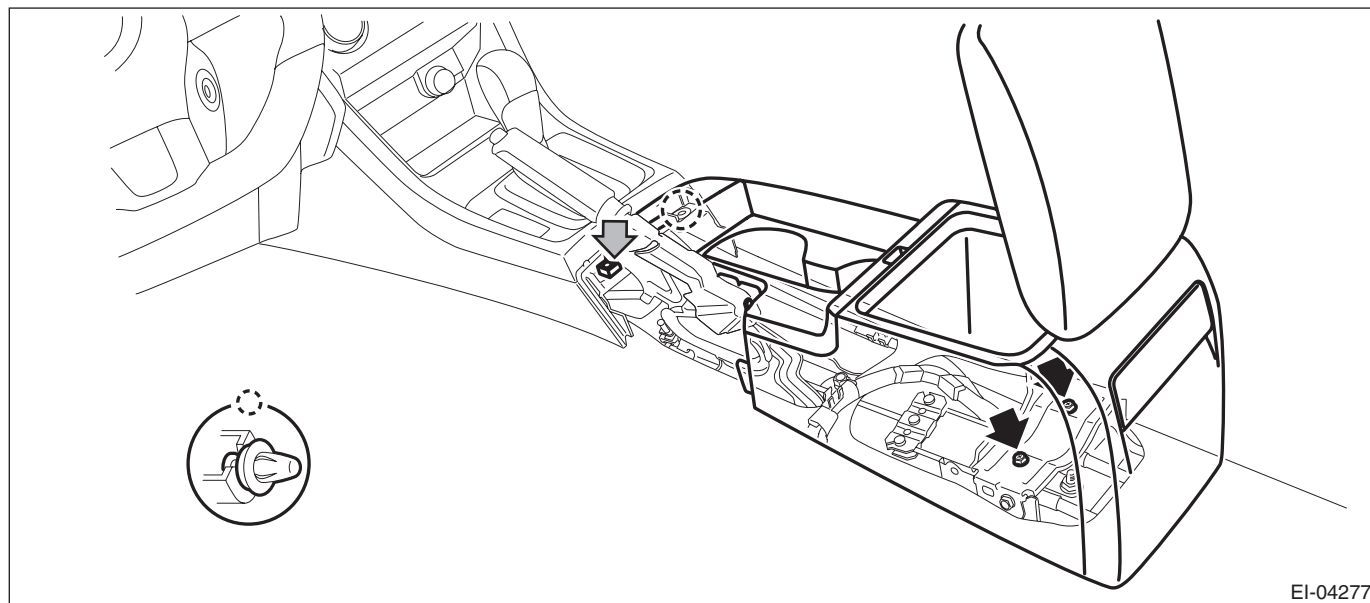

Console Box

EXTERIOR/INTERIOR TRIM

3) Remove the cover - shift lever.

- (1) Remove the shift knob. (MT model)
- (2) Release the clips and claws, then pull up the cover - shift lever.

NOTE:

For vehicles with smart and STI model, disconnect harness connector.

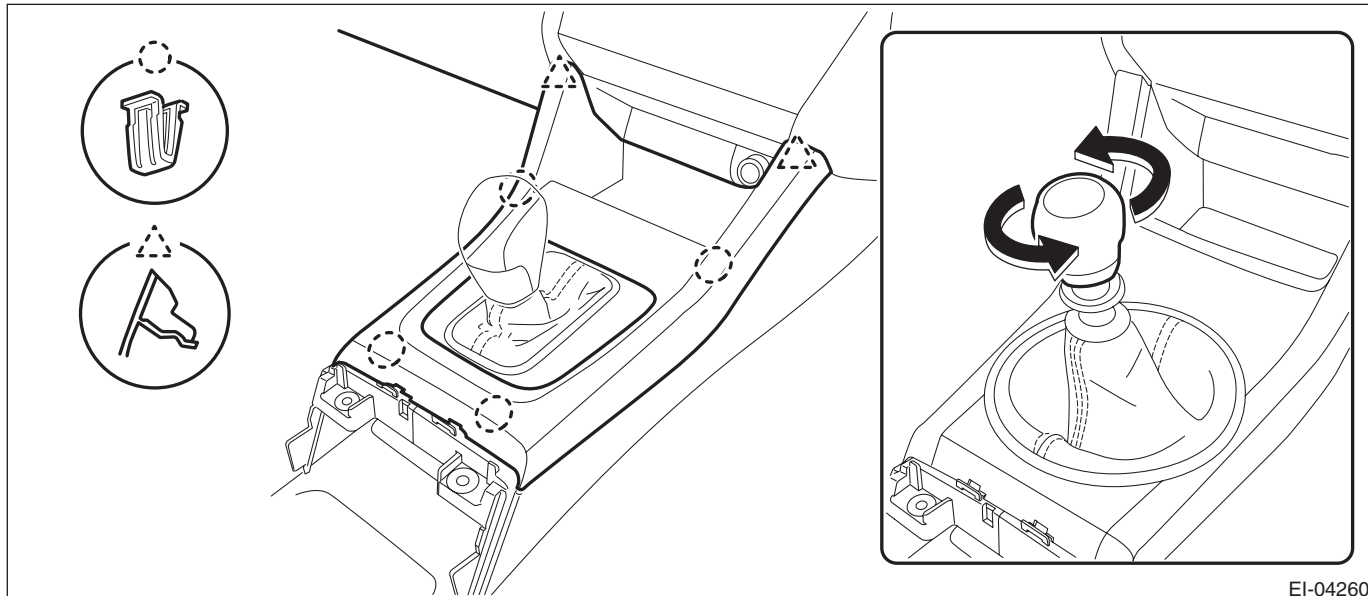

4) Remove the left and right panel center LWR.

- (1) Remove the screws and clips.
- (2) Release the claws, and then pull the panel center LWR to remove.

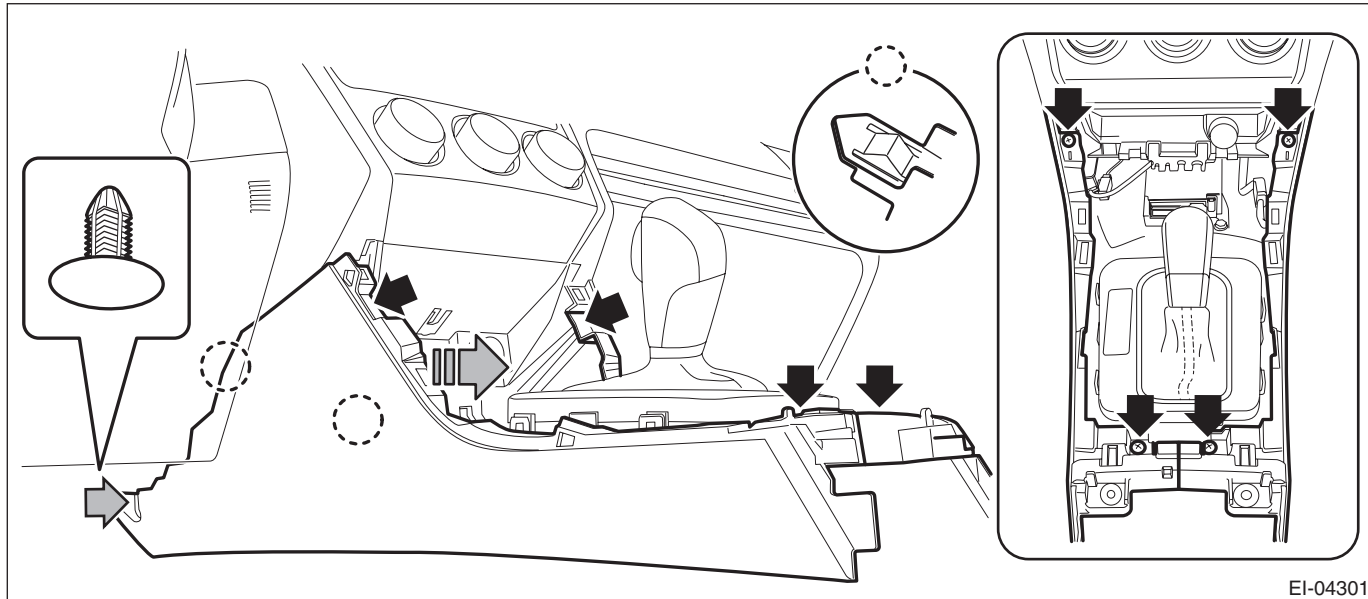

B: INSTALLATION

- 1) Install the panel center LWR.
- 2) Install the cover - shift lever.
- 3) Install the console box assembly.
- 4) Install the boot - hand brake.
- 5) Connect the battery ground terminal. <Ref. to NT-5, BATTERY, NOTE, Note.>

NOTE:

For models other than STI model, connect the ground terminal to battery sensor.